

Schedule 80 Fittings



Tee - Special Reinforced

SR Fipt x SR Fipt x SR Fipt - Stainless Steel Collar

(Continued)

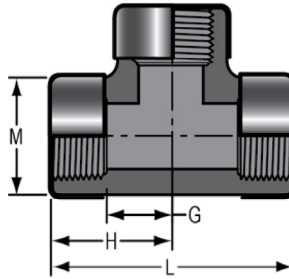

Part Number	Size	G	H	L	M	Approx. Wt. (Lbs.)
805-015SR	1-1/2	1- 1/4	2- 3/16	4-13/32	2-13/32	.66
805-020SR	2	1- 5/8	2- 5/8	5- 1/4	3	1.16

Tee - Street

Spigot x Socket x Socket

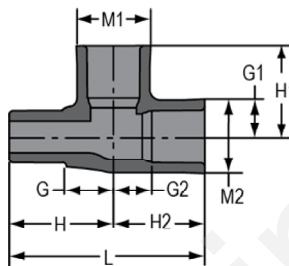

Part Number	Size	G	G1	G2	H	H1	H2	L	M1	Approx. Wt. (Lbs.)
844-005	1/2	23/32	23/32	1/2	1-19/32	1-21/32	1-19/32	3- 5/32	1- 3/16	.10
844-007	3/4	13/16	27/32	7/8	1-13/16	1- 7/8	1-13/16	3- 5/8	1-13/32	.15
844-010	1	1- 3/32	13/16	13/16	2- 7/32	2	2	4- 7/32	1- 3/4	.25
844-012	1-1/4	1- 1/4	1- 5/32	1- 1/8	2- 7/16	2- 5/16	2- 7/16	4- 7/8	2- 3/32	.38
844-015	1-1/2	1-13/16	1- 1/8	1- 1/8	2- 7/8	2- 9/16	2- 9/16	5-11/32	2-11/32	.51
844-020	2	1-23/32	1- 7/16	1-13/32	3- 1/4	2-15/16	2-15/16	6- 5/32	2- 7/8	.78

90° EII

Socket x Socket

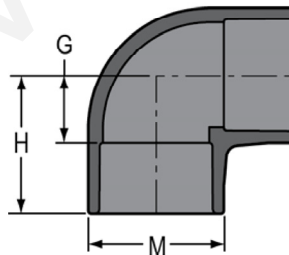

Part Number	Size	G	H	M	Approx. Wt. (Lbs.)
806-002	1/4	11/32	1	13/16	.03
806-003	3/8	15/32	1- 1/4	31/32	.04
806-005	1/2	9/16	1-15/32	1- 3/16	.07
806-007	3/4	5/8	1-11/16	1- 7/16	.11
806-010	1	7/8	2	1- 3/4	.19
806-012	1-1/4	1-1/32	2- 9/32	2-1/8	.29
806-015	1-1/2	1- 5/32	2- 9/16	2- 3/8	.39
806-020	2	1-13/32	2-15/16	2- 7/8	.60
806-025	2-1/2	1- 9/16	3-11/32	3-15/32	1.07
806-030	3	2- 1/16	3-31/32	4- 3/16	1.62



Schedule 80 Fittings

90° EII

Socket x Socket

(Continued)

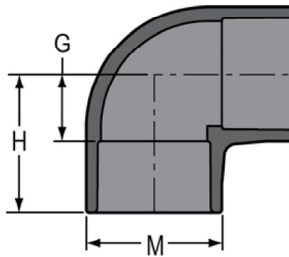

Part Number	Size	G	H	M	Approx. Wt. (Lbs.)
806-040	4	2-19/32	4-27/32	5- 1/4	2.80
806-045F	4-1/2	6- 1/2	9	5- 5/8	4.86
806-050	5	3	5- 3/4	6- 3/8	4.30
806-050F	5	5- 1/2	8- 1/2	6- 5/16	6.22
806-060	6	3- 3/4	6- 3/4	7-19/32	7.46
806-080	8	4-25/32	8-25/32	9- 3/4	14.30
806-080F	8	8-1/2	12-3/4	9-5/8	13.62
806-100	10	5-25/32	10-13/16	12-5/32	26.34
806-100F	10	10	15- 1/4	11-15/16	30.83
806-120	12	6-27/32	12-29/32	14-3/8	42.95
806-120F	12	11- 1/2	17- 3/4	14- 1/8	45.85
806-140	14	7- 1/2	14- 1/2	15-11/16	52.29
806-140F	14	13- 1/2	20- 1/2	15- 1/2	70.94
806-160F	16	15- 9/16	23- 9/16	17-11/16	101.70
806-180F	18	17-11/16	26-11/16	19- 7/8	164.83
806-200F	20	19-13/16	29-13/16	22- 1/16	193.41
806-240F	24	24	36	26- 7/16	324.00

90° EII Sweep

Socket x Socket

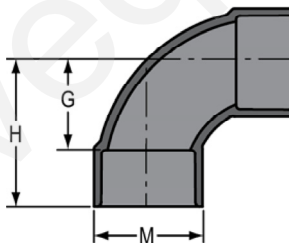

Part Number	Size	G	H	M	Approx. Wt. (Lbs.)
806-005S	1/2	27/32	1-23/32	1- 3/16	.07
806-007S	3/4	1- 1/32	2- 1/32	1-13/32	.11
806-010S	1	1- 5/16	2- 7/16	1-23/32	.19
806-012S	1-1/4	1- 9/16	2-13/16	2- 3/32	.29
806-015S	1-1/2	1- 3/4	3- 1/8	2-11/32	.38
806-020S	2	2- 5/16	3-13/16	2- 7/8	.64