

Schedule 80 Fittings

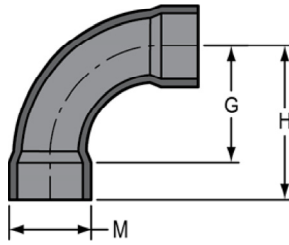

90° EII - Long Sweep

Socket x Socket



Part Number	Size	G	H	M	Approx. Wt. (Lbs.)
806-005LSF	1/2	1- 7/8	2- 3/4	1- 1/8	.12
806-007LSF	3/4	2- 7/16	3- 7/16	1- 7/16	.22
806-010LSF	1	2- 7/8	4	1-11/16	.37
806-012LSF	1-1/4	3- 5/8	4- 7/8	2- 1/16	.55
806-015LSF	1-1/2	4- 1/8	5- 1/2	2- 5/16	.59
806-020LSF	2	4- 3/4	6- 5/16	2-13/16	1.00
806-025LSF	2-1/2	5- 3/4	7- 3/4	3- 7/16	1.56
806-030LSF	3	7	9	4- 1/8	2.31
806-040LSF	4	9	11- 1/4	5- 3/16	3.96
806-060LSF	6	13	16- 1/4	7- 1/2	10.96
806-080LSF	8	23-1/2	27-3/4	9-5/8	28.88

90° EII

Socket x Fipt

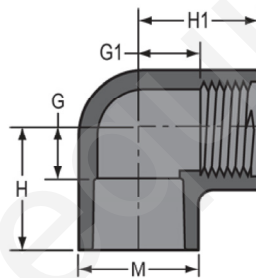

Part Number	Size	G	G1	H	H1	M	Approx. Wt. (Lbs.)
807-002	1/4	5/16	5/16	15/16	15/16	7/8	.03
807-003	3/8	1/4	3/8	1- 1/32	1- 1/32	1- 1/32	.05
807-005	1/2	15/32	9/16	1-11/32	1- 9/32	1- 3/16	.08
807-007	3/4	5/8	5/8	1- 9/16	1- 9/16	1- 3/8	.10
807-010	1	11/16	25/32	1-13/16	1-11/16	1-23/32	.18
807-012	1-1/4	23/32	1- 1/32	1-31/32	1-31/32	2- 1/16	.28
807-015	1-1/2	31/32	1- 7/32	2-11/32	2- 5/32	2-3/8	.39
807-020	2	15/16	1- 1/32	2- 7/16	2	3	.80
807-030	3	1-27/32	2- 7/32	3-23/32	3- 9/16	4- 9/32	1.92
807-040	4	2- 5/16	2- 7/8	4- 9/16	4- 9/32	5- 1/4	2.86
807-060 ¹	6	3- 3/4	7- 1/8	6- 3/4	8- 7/8	7- 9/16	10.35

¹Thread outlet sized with Female Adapter